

Rockustics®

Cherry Bomb Quick-Start Hookup

(For use in 8Ω mode)

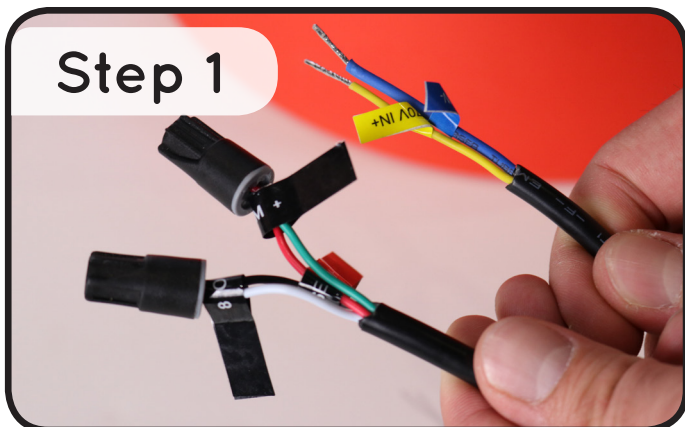

Your wire whips look like this out of the box. All we need for 8Ω wiring are the GREEN and WHITE wires.

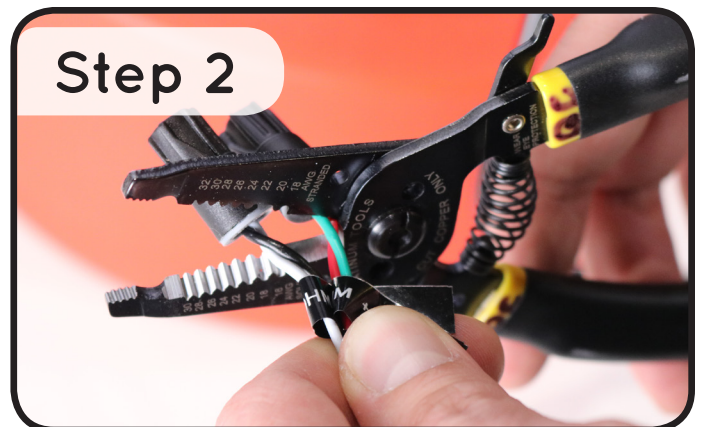

Cut the GREEN, RED, BLACK, and WHITE wires loose from the wire nuts.

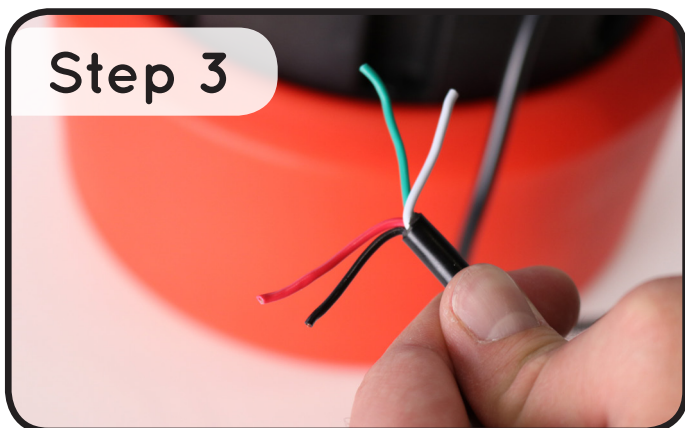

Separate wires.

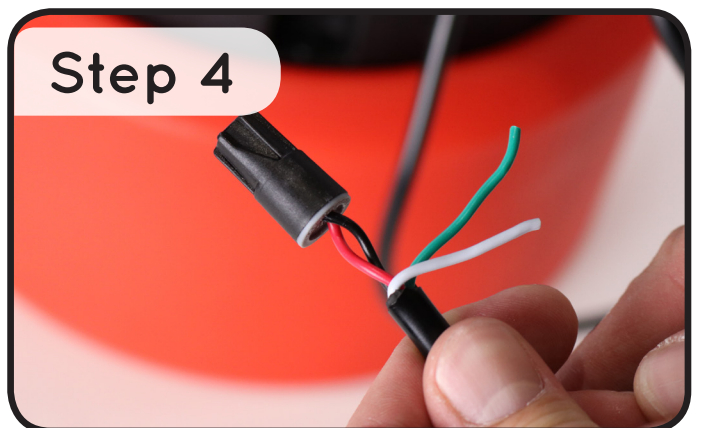

Cap off the RED and BLACK wires, as they are not needed unless you require 70V functionality.

Step 5

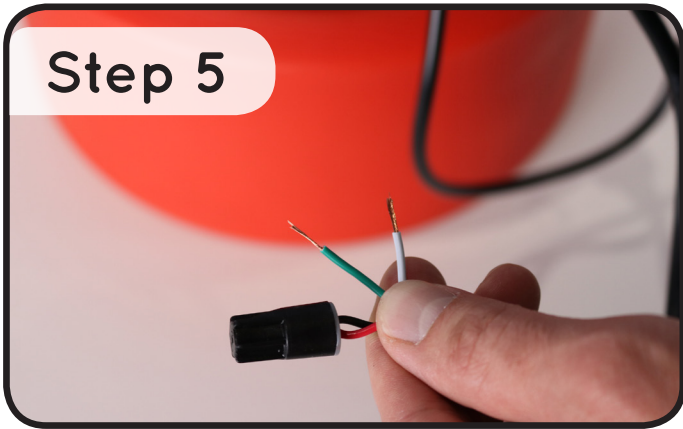

Strip the insulation roughly 1/4" from the GREEN and WHITE wires. The GREEN (+) wire is your positive, while WHITE (-) is negative.

Step 6

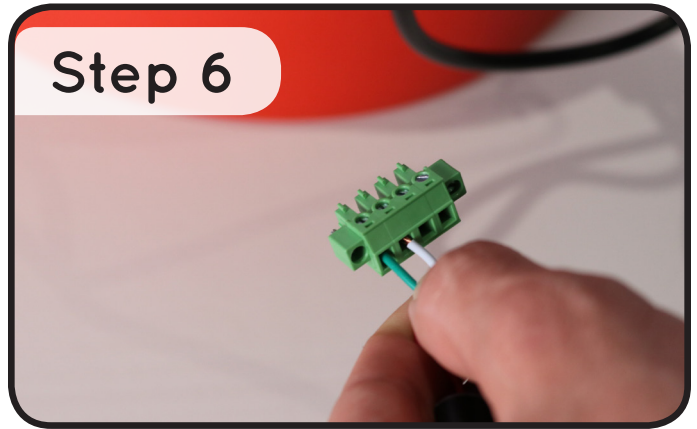

Wire your positive and negative leads according to your amplifier channel configuration. Here we are using the OS-440.

Step 7

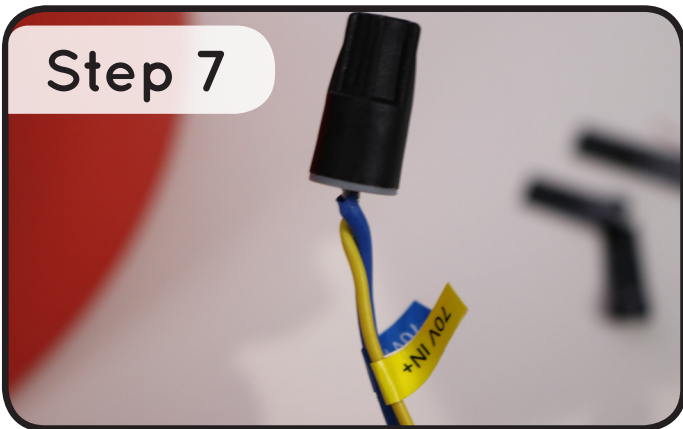

Cap off the BLUE and YELLOW wires, as they are not needed unless you require 70V functionality.

Step 8

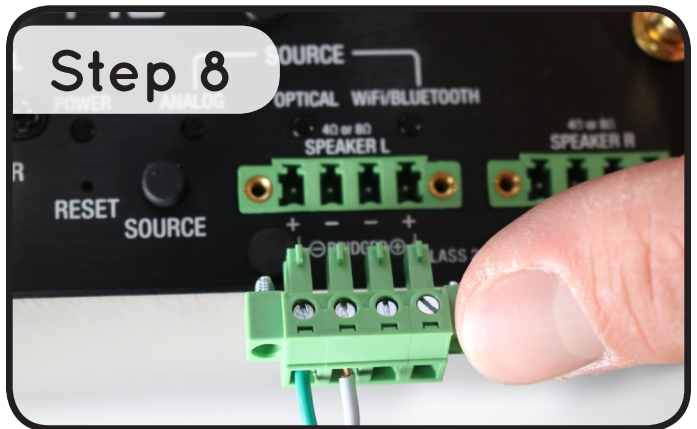

Plug wires into your amplifier.

Step 9



Rock out.

For further support and assistance, contact Rockustics direct:
913.663.5600 | techsupport@mseaudio.com